

	SYM	PART #	DESCRIPTION	QTY.
HARDWARE KIT p/n HDWE-B3	1	AB0041HD	B3 FRAME ASSY, HDG	1
	2	AS REQUIRED	B3 MAST ASSY (DIAMETER & LENGTH AS REQ'D), HDG	1
	3	AB0042LHHD	LH BRACE ANGLE, 23" LONG, HDG	1
	4	AB0042RHHD	RH BRACE ANGLE, 23" LONG, HDG	1
	5	AB1621LHHD	REAR BRACE ANGLE, 28.25" LONG, HDG	1
	6	H1-0375-400TB	3/8" x 4" TAP BOLT (FULLY THREADED)GR.5, Z/P	2
	7	H3-0375FW	3/8" USS FLATWASHER, Z/P	2
	8	H2-0375WN	3/8" WHIZ LOCK NUT, Z/P	2
	9	H1-0375-100	3/8" x 1" BOLT GR.5, Z/P	5
	10	H2-0375HN	3/8" NUT, Z/P	5
	11	H4-0375LW	3/8" SPLIT-LOCKWASHER, Z/P	5
			1/8" THICK RUBBER PAD 18"x48"	2

**PROPRIETARY AND CONFIDENTIAL**

THE INFORMATION CONTAINED IN THIS DRAWING IS THE SOLE PROPERTY OF BAIRD SUPPORTING SYSTEMS. ANY REPRODUCTION IN PART OR AS A WHOLE WITHOUT THE WRITTEN PERMISSION OF BAIRD SUPPORTING SYSTEMS IS PROHIBITED.



WWW.BAIRD MOUNTS.COM

UNLESS OTHERWISE SPECIFIED:

DIMENSIONS ARE IN INCHES  
TOLERANCES:  
FRACTIONAL ±  
ANGULAR: MACH ± BEND ±  
TWO PLACE DECIMAL ±  
THREE PLACE DECIMAL ±

DO NOT SCALE DRAWING

**BAIRD MOUNTING SYSTEMS**

WATERLOO, IA 50703  
PHONE: 319-233-3561  
SALES@BAIRDMOUNTS.COM

TITLE:

B3-34X40 with PAD  
ASSEMBLY INSTRUCTIONS

DRAWN BY  
JK

MATERIAL

DWG. PURPOSE  
INST

PART. NO.

B3-(000)X( )-R

DWG. NO.

B3-(000)X( )-R INST

DATE  
10/09/14

FINISH

SHEET  
1 OF 2

SCALE  
-

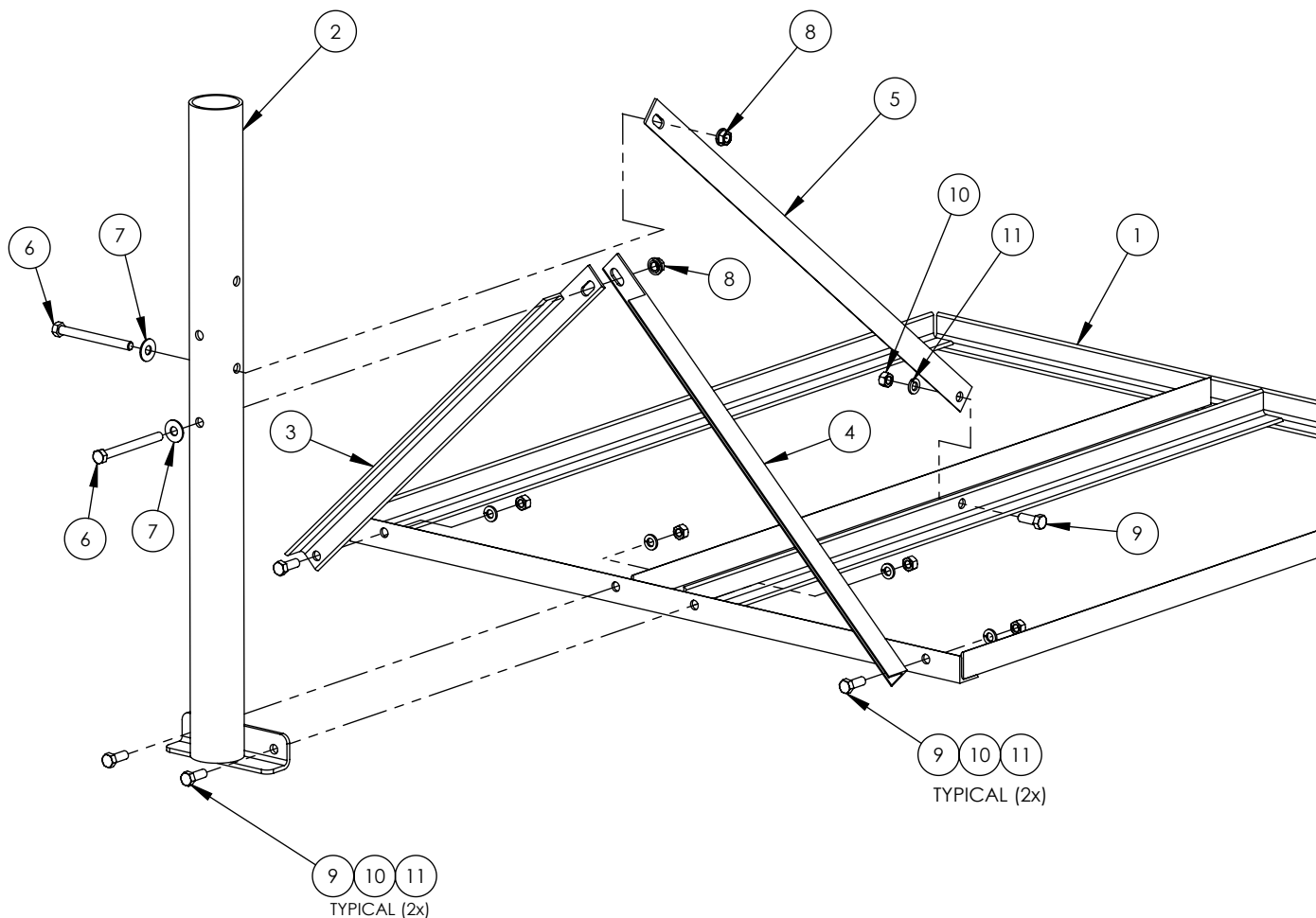

**PROPRIETARY AND CONFIDENTIAL**

THE INFORMATION CONTAINED IN THIS DRAWING IS THE SOLE PROPERTY OF BAIRD SUPPORTING SYSTEMS. ANY REPRODUCTION IN PART OR AS A WHOLE WITHOUT THE WRITTEN PERMISSION OF BAIRD SUPPORTING SYSTEMS IS PROHIBITED.



WWW.BAIRD MOUNTS.COM

**UNLESS OTHERWISE SPECIFIED:**

DIMENSIONS ARE IN INCHES  
TOLERANCES:  
FRACTIONAL  $\pm$   
ANGULAR: MACH  $\pm$  BEND  $\pm$   
TWO PLACE DECIMAL  $\pm$   
THREE PLACE DECIMAL  $\pm$

DO NOT SCALE DRAWING

**BAIRD MOUNTING SYSTEMS**

WATERLOO, IA 50703  
PHONE: 319-233-3561  
SALES@BAIRDMOUNTS.COM

**TITLE:**

B3-34X40 with PAD  
ASSEMBLY INSTRUCTIONS

**DRAWN BY**

JK

**MATERIAL**

-

**DWG. PURPOSE**

INST

**DATE**

10/09/14

**FINISH**

-

**SHEET**

2OF2

**SCALE**

-

**PART. NO.**

B3-(000)X( )-R

**DWG. NO.**

B3-(000)X( )-R INST

rev. 03/24